

C 65-210

John Gilmer

C 65-297

C 59-69

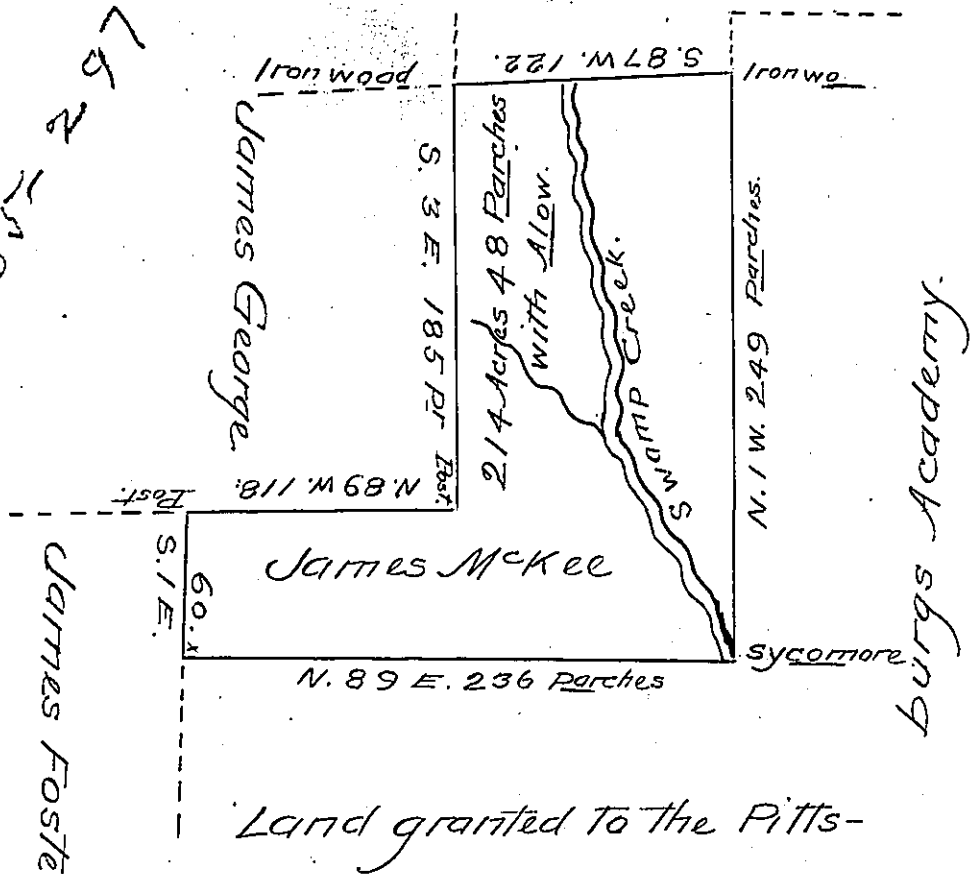

SITUATE upon Wolfcreek in Wolfcreek Township  
 Mercer County Containing two hundred and fourteen  
 Acres and forty eight ~~Acres~~ perches with Allowance  
 of Six per cent for Roads &c. Surveyed August 16<sup>th</sup>  
 1805 in pursuance of a Warrant Granted to James  
 McKee Dated the 8<sup>th</sup> Day of April A.D. 1805

John Findley D.S.

To Saml Cochran Esq. S.G.

IN TESTIMONY that the above is a copy of the original remaining on file in  
 the Department of Internal Affairs of Pennsylvania, made  
 conformably to an Act of Assembly approved the 16th day of  
 February, 1833, I have hereunto set my Hand and caused  
 the Seal of said Department to be affixed at Harrisburg,  
 this Twenty second day of December 1905.

*George R. ...*  
 Secretary of Internal Affairs.